

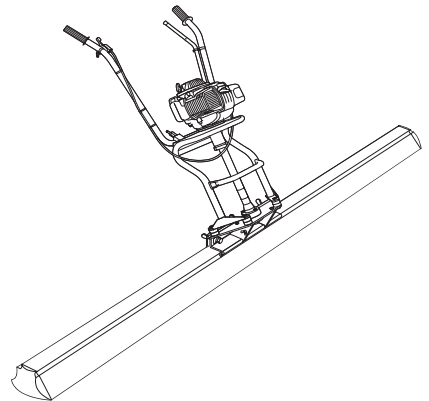

EASYSCREED PRO

**Ⓞ GB VIBRATING SCREED
OPERATOR MANUAL**



157.2.000 Rev 0

This manual has been written to help you operate and service the 'Easy Screed Pro' safely. This manual is intended for dealers and operators of the 'Easy Screed Pro'.

Foreword

The '**Machine Description**' section helps you to familiarise yourself with the machine's layout and controls.

The '**Environment**' section gives instructions on how to handle the recycling of discarded apparatus in an environmentally friendly way.

The '**Safety Instructions**' and '**Health and Safety**' sections explain how to use the machine to ensure your safety and the safety of the general public.

The '**Trouble Shooting**' guide helps you if you have a problem with your machine.

The '**Service & Maintenance**' section is to help you with the general maintenance and servicing of your machine.

The '**Replacement Parts**' section provides instructions on how to order and specify replacement parts, if the need arises.

The '**Warranty**' Section details the nature of the warranty cover and the claims procedure.

The '**Machinery Directive**' section shows the standards that the machine has been built to.

Directives with regard to the notations.

Text in this manual to which special attention must be paid are shown in the following way:



CAUTION

The product can be at risk. The machine or yourself can be damaged or injured if procedures are not carried out in the correct way.



WARNING

The life of the operator can be at risk.

Warning



Before you operate or carry out any maintenance on this machine **YOU MUST READ** and **STUDY** this manual.

KNOW how to safely use the unit's controls and what you must do for safe maintenance.

(NB Be sure that you know how to switch the machine off before you switch on, in case you get into difficulty.)

ALWAYS wear or use the proper safety items required for your personal protection.

If you have **ANY QUESTIONS** about the safe use or maintenance of this unit, **ASK YOUR SUPERVISOR OR CONTACT THE BELLE GROUP: +44 (0) 1246 473232**

Contents



How to use this manual	2
Warning	3
Machine Description	4
Technical Data	5
Environment	5
Safety Instructions	6
Health and Safety	7
Warning Decals	7
Operating Instructions.....	8 - 11
Service & Maintenance	12
Trouble Shooting Guide	13
Replacement Parts	13
Warranty	14
Machinery Directive	15

Belle Group reserves the right to change machine specification without prior notice or obligation.

The Easy Screed Pro uses a unique reversible blade design which can be used for standard form-to form screeding or free screeding. It is supplied in 2 components: the beam and the power unit. The power-unit consists of a twin handle, between which the petrol engine is located. The engine drives, by means of a flexible shaft, the vibrator which is adjustable in 4 positions. The power-unit is equipped with a quick disconnect system, which allows the attachment of various beam widths, within minutes. With the vibrating aluminium profile of the Easy Screed Pro, the top layer of freshly poured concrete is compacted, levelled and smoothed in one operation.

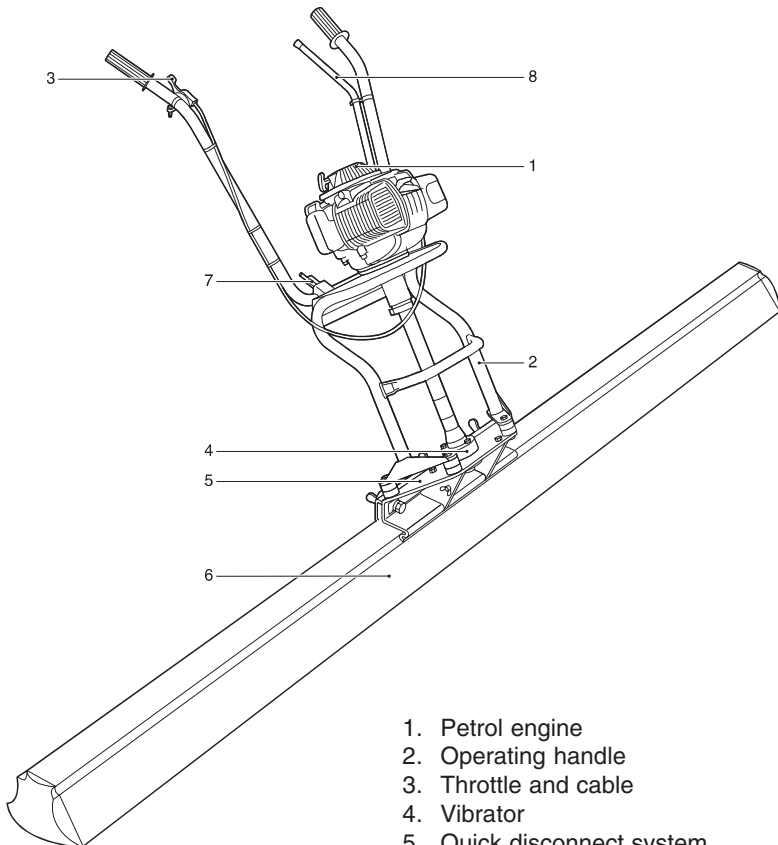

1. Petrol engine
2. Operating handle
3. Throttle and cable
4. Vibrator
5. Quick disconnect system
6. Aluminium blade
7. Lock, adjustable control handle
8. Support

Technical Data



System process	Concrete compaction, smoothing and leveling.
Process	Generating mechanical vibrations via petrol-engine.
Execution	Portable
Max. Working size	6m x 0.45m x 1m
Beam widths available	Metres: 1.5, 1.9, 2.5, 3, 3.75, 4.25, 5, 5.5*, 6* Feet: 5, 6, 8, 10, 12, 14, 16, 18*, 20*
System mass	Operation unit with petrol engine: 14.5 Kg. Aluminium profile: 4.6 Kg/m.
Engine model	Honda GX-31 4-Stroke Petrol engine
Capacity	1.1 Kw / 1.5 HP
Fuel	Euro unleaded (no fuel mix)
Noise production	50 dB (A) In open air max.
Drive system	Flexible system
Vibration acceleration	< 1.5 m/s ²
Sealing	IP54, Splashproof
Maintenance	Clean with water and brush

* Use 2 vibrating units when working with 5,5m (18Ft) and 6m (20Ft) beams

Environment



Safe Disposal.



Instructions for the protection of the environment.

The machine contains valuable materials. Take the discarded apparatus and accessories to the relevant recycling facilities.

Component	Material
Twin handle control	Steel
Hose connectors	Steel
Eccentric weights	Steel
Flexible shaft	Steel
Aluminium profile	Aluminium
End cover profile	Synthetic material
Petrol engine housing	Aluminium
Petrol engine covers	Synthetic material
Various parts	Steel & Aluminium

For your own personal protection and for the safety of those around you, please read and ensure you fully understand the following safety information. It is the responsibility of the operator to ensure that he/she fully understands how to operate this equipment safely. If you are unsure about the safe and correct use of the 'Easy Screed Pro', consult your supervisor or Belle Group.

**CAUTION**

Improper maintenance can be hazardous. Read and Understand this section before you perform any maintenance, service or repairs.

- Ensure, that all symbols on the machine, can always be clearly read.
- Do not leave any tools or parts lying around on the work floor, as this can cause accidents.
- Watch where you are going, the ground can be slippery.
- Take care that you do not injure yourself on objects, such as scaffolding and reinforcement materials, which can be found directly or indirectly in the working area.
- Be careful when lifting and carrying the Easy Screed Pro. Do not bend forwards when picking up the apparatus, bend your knees. Ensure that the working area is within your reach, that you do not have to bend forward.
- When cleaning the machine, ensure that no water or cleaning detergents get into the motorhousing.
- When the machine is not being used for longer periods of time, then it must be stored in a dry and clean area.
- Pay attention to your own safety and the safety of your colleagues.
- Regular maintenance of the machine promotes safe operation.

The following safety-aspects specifically apply to those machines equipped with a petrol engine:

- Do not use an Easy Screed Pro, fitted with a petrol engine, indoors or in poorly ventilated places, such as pits etc.
- Make sure that there is sufficient ventilation in spaces which are surrounded by walls. Never inhale exhaust gasses, they can damage your health and that of your colleagues.
- To avoid getting an electric shock, do not touch the high-tension cable or spark plug cap while the engine is running.
- Check for fuel leaks before running the machine.
- Do wear working-gloves, safety glasses and protecting clothing during refuelling.
- Make sure that there is sufficient ventilation during refuelling.
- Refuelling is only allowed after the engine has been cooled off sufficiently.
- Refuelling, while the engine is hot, might lead to a very dangerous situation. It is strictly forbidden to refuel :
 - in the direct vicinity of open fire or other flammable materials,
 - while smoking cigarettes etc.
 - in explosion endangered spaces.

Vibration

Some vibration from the poker is transmitted through the flexible hose to the operator's hands.

PPE (Personal Protective Equipment).

Suitable PPE must be worn when using this equipment i.e. Safety Goggles, Gloves, Ear Defenders, Dust Mask and Steel Toe capped footwear (with anti-slip soles for added protection). Wear clothing suitable for the work you are doing. Always protect skin from contact with concrete.

Warning Decals

Explanation of the safety symbols used:



4.



7.

1. Safety glasses, safety helmet and ear protection compulsory.
2. Working gloves compulsory.
3. Safety shoes with extra protection compulsory.
4. Dangerous electrical voltage.
5. Read the operator manual provided.
6. Inflammable material.
7. Warning! Do not clean the Easy Screed Pro with a high pressure cleaner.



Before you operate or carry out any maintenance on this machine **YOU MUST READ** and **STUDY** this manual.

How to assemble the Easy Screed Pro.

1. First determine whether you want to use the Easy Screed Pro as a form-to form screeder or as a free screeder.
2. The Easy Screed Pro is supplied in 2 components: the power-unit and the beam profile.
3. The power-unit is equipped with a quick disconnect system, with which the powerunit can be mounted on to the beam profile.
4. To connect the power-unit to the beam profile loosen the 3 wingbolts (2) about 8mm, until the front clamping plate(3) fits into the collar of the profile. Now tighten the 3 wingbolts (2).

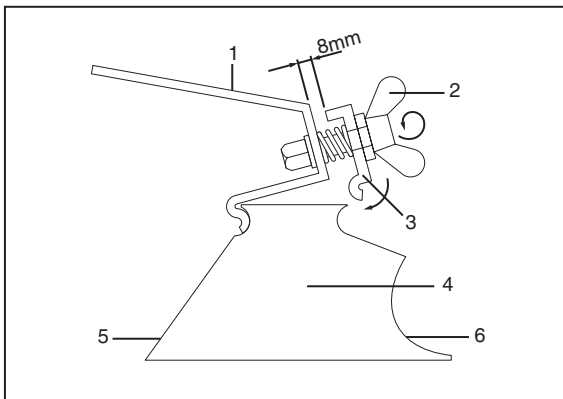

CAUTION

Make sure that the unit is mounted between the 2 indication arrows, located on the beam.

5. Now unfold the twin control handle, adjust it to the proper height, and tighten the 2 clamps.
6. Make sure that the Easy Screed Pro is properly assembled and that the **ON-OFF** switch is in the **ON** position.
7. Make sure that the fuel tank is filled with unleaded fuel only.
8. In case the Easy Screed Pro is used for form-to-form screeding make sure that the forms are set to the right level.

Operation and use of the Easy Screed Pro.

1. Place the Easy Screed Pro beam on the rail supports or if you want to use the Easy Screed Pro as a free screed, directly on the freshly poured concrete surface.



CAUTION

Before starting the petrol engine read the enclosed operation instructions carefully. Make sure before starting that the **ON-OFF** switch is in the **ON** position.

2. Now start the engine and allow a three minute warming-up period before setting the throttle handle to the desired engine speed.
3. After setting the engine speed start moving the Easy Screed-Pro backwards, the travel-speed depends on the consistency of the concrete.
4. If the Easy Screed Pro vibrates too strong the centrifugal force needs to be reduced. This is done by first removing the vibrator's protection cover and adjust the eccentric weights to a lower centrifugal force (See below). A well adjusted screeder will create a level, smooth and shining surface.

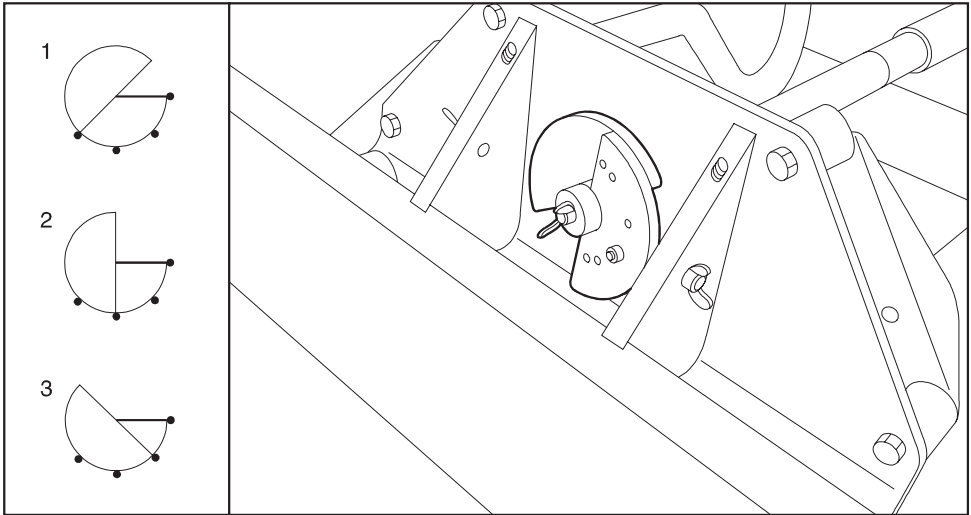

5. After the job is finished, remove the Easy Screed Pro from the concrete and switch off the petrol engine.
6. After use, clean the Easy Screed Pro according to the instructions described in the Maintenance section of this manual. Place the Easy Screed Pro on a dry, clean and stable surface.
7. If you do not expect to use the engine for a long period of time, drain the fuel tank and let the engine run at idle speed until the fuel in the carburettor is used and the engine stops.



Operating Instructions

Please observe the following instructions:

- Make sure to refill the fuel tank in time. Do not let the engine run so all the fuel is used. This might cause starting problems.
- Prevent the Easy Screed Pro of sinking into the concrete. After the engine has been switched on, immediately move the Easy Screed Pro backwards.
- When using a low slump concrete, move the Easy Screed Pro slowly across the surface of the concrete. When using a high slump concrete, move the Easy ScreedPro faster across the surface of the concrete.
- When the Easy Screed-Pro is used as a wet screed it is recommended to first compact the freshly poured concrete with a poker vibrator while at the same time set the height of the floor by means of a laser device.

How to adjust the centrifugal force:

1. Remove the protecting cover of the vibrator by loosening the 2 wingbolts.
2. Loosen the wingbolt of the vibrator and adjust the vibrator in accordance with the indicated positions, refer to previous page.
3. Retighten the wingbolt and refix the protective cover.

NOTE: It is possible to increase/decrease the centrifugal force by operating the throttle.

Operating the Easy Screed Pro

The drive-unit of the Easy Screed Pro (Petrol engine) is started by pulling the recoil-starter of the engine. The vibrating beam of the Easy Screed Pro compacts, levels and smooths freshly poured concrete in one operation. The Easy Screed Pro features a dualpurpose beam and can be used for form-to-form screeding or for free screeding.

By rotating the power-unit 180 degrees, the operator can choose between screeding, using forms/rails, or free screeding.

(Below) The Easy Screed-Pro in action as a free screeder (free screeding side in direction of arrow)

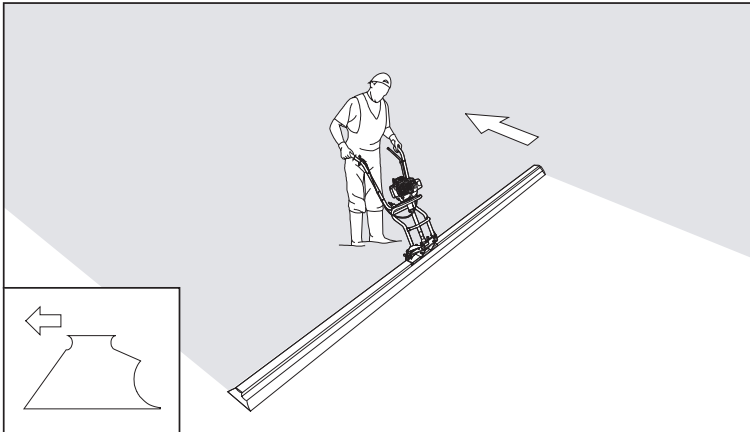

(Below) The Easy Screed-Pro in action as a form to form screeder (cutting side in direction of arrow)

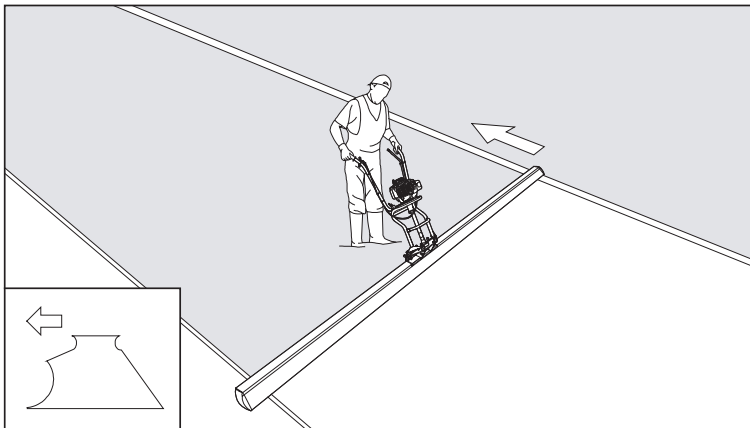

Maintenance

The Belle Group 'Easy Screed Pro' is designed to give many years of trouble free operation. It is recommended that an approved Belle Group dealer carries out all major maintenance and repairs. Always use genuine Belle Group replacement parts, the use of spurious parts may void your warranty.

- It is recommended to spray the aluminum blade and quick disconnect prior to operation, with a high quality form oil (Areas 1 & 2).

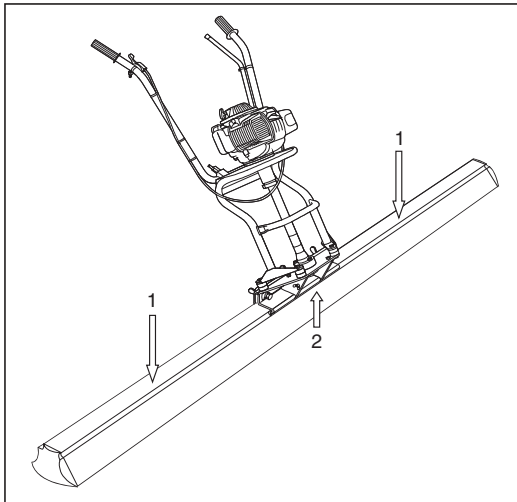

- Clean the quick disconnect and beam on a daily basis.
- Only qualified personnel, familiar with the contents of this operation manual, are allowed to carry out maintenance and repair jobs to the Easy Screed Pro.
- After use store the Easy Screed Pro in a clean, dry and dust free place.



CAUTION

Concrete remnants could damage the beam and quick disconnect. Remove concrete remnants from the beam and connector before they harden. They could easily injure the operator.



CAUTION

Do not clean the Easy Screed-Pro with a high pressure cleaner.

Daily service

In order to achieve a maximum cooling effect the ventilation openings must stay free from dirt, grease and concrete. Check them at the end of each working day. If necessary clean them with a brush or a damp cloth. For detailed engine servicing instructions, please read the operation instructions supplied by the manufacturer.

If the Easy Screed Pro is not operating properly then one or more of the following problems could be the cause.

- Problem:** The Easy Screed Pro, used as a form-to-form screeder, vibrates too much and does not travel smoothly across the form work.
- Cause:** The vibrator vibrates too much for the chosen working width and is therefore very unstable on the form work and cannot travel or function in the proper way.
- Solution:** Refer to the Operation section of this manual for instructions on how to adjust the centrifugal force.
-
- Problem:** The Easy Screed-Pro has insufficient vibration and as a result the concrete floor cannot be leveled and smoothed in the proper way.
- Cause:**
1. The centrifugal force of the vibrator is set too low.
 2. There is an excess of concrete in front of the leading edge.
 3. The chosen width of the beam is too big.
- Solution:**
1. Increase the centrifugal force of the vibrator, (Refer to the Operation section of this manual for instructions on how to adjust the centrifugal force).
 2. Make sure to maintain a roll of concrete of 20 to 30mm evenly spread out along the front of the leading beam.
 3. Choose a smaller profile width, or fit 2 drive units to 5.5 or 6 meter beams
-
- Problem:** The Easy Screed-Pro engine fails to start or runs irregularly.
- Cause:**
1. Insufficient fuel in the fuel tank,
 2. The starting procedure was not executed in the proper way.
 3. A failure in the engine.
- Solution:**
1. Refill the fuel tank,
 2. Read the operation instructions of the gasoline engine carefully and repeat the starting procedure.

Replacement Parts



Refer to the exploded view and relevant component list. When ordering replacement parts please make sure you have the following information ready:

1. Machine type and model number.
2. The part number (not the illustration number).
3. The correct address to where the parts are to be delivered.



Warranty

Your new Belle Group 'Easy Screed Pro' is warranted to the original purchaser for a period of one-year (12 months) from the original date of purchase. The Belle Group warranty is against defects in design, materials and workmanship.

The following are not covered under the Belle Group warranty:

1. Damage caused by abuse, misuse, dropping or other similar damage caused by or as a result of failure to follow assembly, operation or user maintenance instruction.
2. Alterations, additions or repairs carried out by persons other than the Belle Group or their recognised agents.
 - The ventilation slots are not cleaned regularly,
 - Unqualified personnel (not familiar with the contents of this operation manual) have assembled or dismantled the Easy Screed Pro.
 - The Easy Screed Pro has been stored in a damp environment.
 - The Easy Screed Pro has been cleaned with a high pressure cleaner or by water jet under high pressure.
3. Transportation or shipment costs to and from Belle Group or their recognised agents, for repair or assessment against a warranty claim, on any machine.
4. Materials and/or labour costs to renew, repair or replace components due to fair wear and tear.

The following components are not covered by warranty:

- Engine air filter
- Engine spark plug

The Belle Group and/or their recognised agents, directors, employees or insurers will not be held liable for consequential or other damages, losses or expenses in connection with or by reason of or the inability to use the machine for any purpose.

Warranty Claims

All warranty claims should firstly be directed to Belle Group, either by telephone, by Fax, by E-mail, or in writing.

For warranty claims:

Belle Group Chesterfield Warranty Department,
Speedwell Industrial Estate,
Staveley,
Chesterfield,
Derbyshire S43 3PG,
England
Tel: +44 (0)1246 473232
Fax: +44 (0)1246 477257
Email : warranty@belle-group.co.uk

89/392/EEC

(Annexe 11, under A)

EC-Declaration of Agreement for Machinery

Manufactured for: BELLE GROUP CHESTERFIELD UK

Manufactured by: Bouwmachiefabriek Lievers B.V.,
Gr. Mijdrechtstraat 68,
3641 RW Mijdrecht,
Netherlands

We hereby certify that the machinery stipulated below complies with all the relevant provisions of the EC Machinery Directive and the National Laws and Regulations adopting this Directive.

Modifications to the machine without prior approval from the undersigned will render this declaration null and void.

TYPE: **Vibrating Screed**
BRAND: **Easy Screed Pro**
MODEL: **Petrol**
CODE: **157**

MANUFACTURE No:

MANUFACTURE Date:

Harmonised Standards Applied:

- NEN-EN 292 Part 1 : 1994-** Safety of Machinery - Basic concepts, general principles for design. Part 1 - Basic terminology, methodology.
- NEN-EN 292 Part 2 : 1996 -** Safety of Machinery - Basic concepts, general principles for design. Part 2 - Technical principles and Specifications.
- NEN - EN 60335 - 1 (1995)**
- NEN - EN 55014 (1994)**
- NEN - EN 60204-1 (1995)**
- NEN - EN 50144- 2 - 11 (1996).**

Director



Mr J. F. Lievers



Belle Group Chesterfield UK

Speedwell Industrial Estate

Staveley, Chesterfield

Derbyshire. S43 3PG GB

 +44(0)1246 473232

 +44(0)1246 474296

 sales@belle-group.co.uk

<http://www.belle-group.co.uk>